

vtech[®]
Baby

User's Manual

Sing and Soothe Mobile



© 2015 VTech
Printed in China
91-002376-018 UK

VTech understands that a child's needs and abilities change as they grow and with that in mind we develop our toys to teach and entertain at just the right level...

vtech Baby

Toys that will stimulate their interest in different textures, sounds and colours

I am...

...responding to colours, sounds and textures

...understanding cause and effect

...learning to touch, reach, grasp, sit-up, crawl and toddle

Birth-36 months



Pre-School

Interactive toys to develop their imagination and encourage language development

I want...

...to get ready for school by starting to learn the alphabet and counting

...my learning to be as fun, easy and exciting as can be

...to show my creativity with drawing and music so my whole brain develops

3-6 years



4-10 years



Electronic Learning Computers

Cool, aspirational and inspiring computers for curriculum related learning

I need...

...challenging activities that can keep pace with my growing mind

...intelligent technology that adapts to my level of learning

...National Curriculum based content to support what I'm learning at school

To learn more about this and other VTech® products, visit www.vtech.co.uk

INTRODUCTION

Thank you for purchasing the **VTech® Sing and Soothe Mobile** learning toy!

The **VTech® Sing and Soothe Mobile** plays 4 soothing sung songs, 40 relaxing melodies and peaceful nature sounds whilst the activity panel emits a calming glow. The leaves spin gently around, while the five beautifully coloured dangling characters turn round and round with the music to help lull baby to sleep. The adjustable timer setting allows parents to select the time that best suits baby's needs.

TURNING MOBILE

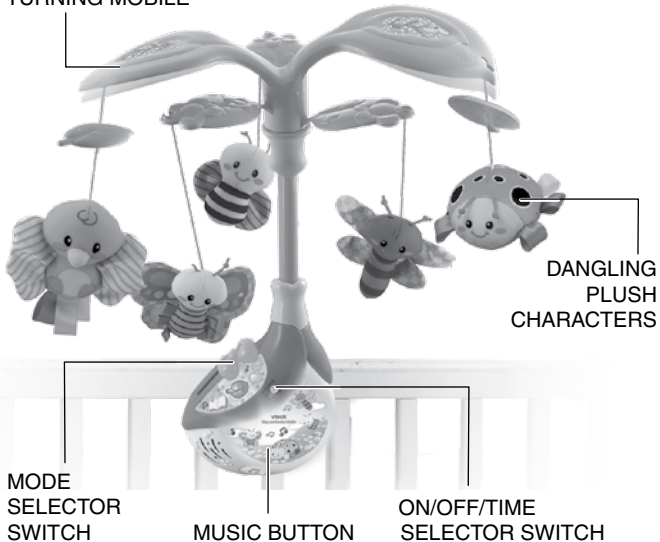

INCLUDED IN THIS PACKAGE

- One VTech® Sing and Soothe Mobile activity panel
- One turning leaf
- One support post
- Five plush dangling characters
- One instruction manual
- Two cot attachment straps

WARNING: All packing materials, such as tape, plastic sheets, packaging locks and tags are not part of this toy, and should be discarded for your child's safety.

NOTE: Please keep user's manual as it contains important information.

GETTING STARTED

BATTERY INSTALLATION

1. Make sure the unit is turned **OFF**.
2. Locate the battery cover on the back of the unit. Use a coin or a screwdriver to loosen the screw.
3. Install 4 new AA (AM-3/LR6) batteries following the diagram inside the battery box.
4. Replace the battery cover and tighten the screw to secure the battery cover.

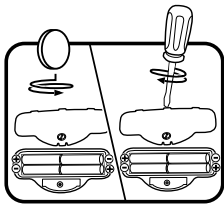

BATTERY NOTICE

- Use new alkaline batteries for maximum performance.
- Use only batteries of the same or equivalent type as recommended.
- Do not mix different types of batteries: alkaline, standard (carbon-zinc) or rechargeable (Ni-Cd, Ni-MH), or new and used batteries.
- Do not use damaged batteries.
- Insert batteries with the correct polarity.
- Do not short-circuit the battery terminals.
- Remove exhausted batteries from the toy.
- Remove batteries during long periods of non-use.
- Do not dispose of batteries in fire.
- Do not charge non-rechargeable batteries.
- Remove rechargeable batteries from the toy before charging (if removable).
- Rechargeable batteries are only to be charged under adult supervision.

Disposal of batteries and product



The crossed-out wheellie bin symbols on products and batteries, or on their respective packaging, indicates they must not be disposed of in domestic waste as they contain substances that can be damaging to the environment and human health.



The chemical symbols Hg, Cd or Pb, where marked, indicate that the battery contains more than the specified value of mercury (Hg), cadmium (Cd) or lead (Pb) set out in Battery Directive (2006/66/EC).

The solid bar indicates that the product was placed on the market after 13th August, 2005.

■ Help protect the environment by disposing of your product or batteries responsibly.

For more information, please visit:

www.recycle-more.co.uk

www.recyclenow.com

DEMO TAG

The demo tag should be removed automatically when the product is taken out of the packaging. If the demo tag is still in position, please remove the plastic strip from the back of the product before placing in the cot. This will activate normal play.

With the **Sing and Soothe Mobile**, safety comes first.

- Keep the mobile out of baby's reach. To avoid entanglement injuries, please remove the mobile portion from the cot once baby begins sitting or pushing up on all fours.
- Age range of mobile - Birth to 5 months
- The cot mobile is intended for visual stimulation and is not intended to be grasped by a child.
- If attached to the cot, remove when your baby begins to push up on hands and knees.
- Always attach all provided fasteners (strings, straps, clamps, etc.) tightly to a cot or playpen according to the instructions. Check frequently. Attach only to cots with sturdy rails and spindles. Do not attach to playpens with mesh walls.
- Do not add additional strings or straps to attach to a cot or playpen.
- To ensure your child's safety, the product should be assembled by an adult.
- Make sure the cot attachment straps are out of your child's reach.
- When removing the **VTech® Sing and Soothe Mobile** from the cot, please detach the cot attachment straps from the unit, and keep the straps out of your child's reach.

Assembly Instructions

1. Take the cord with both a dangling character and leaf piece, then thread it up through the bottom of the hole on the large leaf. Set the knot so it rests on the smaller hole on the leaf.
2. Take the cord with just a dangling character piece and slide it through the slit in the leaf. Set the knot so it rests securely in the hole on the leaf.
3. Attach the turning leaf piece into the recessed slot on top of the mobile support post. You will hear a click when the post is inserted correctly.
4. Attach the bottom of the mobile support post into the recessed slot on the top of the activity panel. You will hear a click when the post is inserted correctly.
5. Place the unit in the cot against the top rail. Press the yellow button and slide the cot attachment strap up through the slot behind the button. Repeat with the second cot attachment strap.

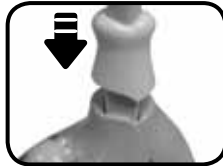
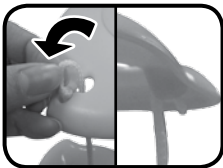

6. Tie the cord securely around the nearest spindle. Pull slightly on the unit to make sure the straps have been securely fastened. The unit should be tight against the cot rail. Check the unit regularly to ensure it is secure.
7. To detach the mobile from the activity panel, press the small yellow button on the back of the activity panel and pull up on the mobile support post.
8. To detach the cot attachment straps, open the battery door, then slide the switches next to the straps toward the centre of the activity panel and pull the cot attachment straps free.

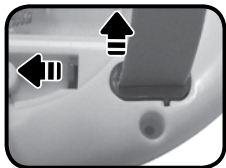
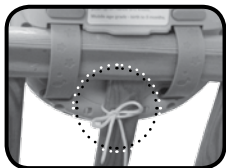

NOTE: The unit without mobile leaves and pole can be removed from the cot and placed on a table.

PRODUCT FEATURES

1. **ON/OFF/TIME SELECTOR SWITCH**
To turn the unit **ON**, slide the **ON/OFF/TIME SELECTOR SWITCH** to the 10, 15 or 20 minute time setting. To turn the unit **OFF**, slide the **ON/OFF/TIME SELECTOR SWITCH** to the **OFF(●)** position.



2. MODE SELECTOR SWITCH

Slide the **MODE SELECTOR SWITCH** to choose one of the three play modes.



3. MOBILE/LIGHT PLAY SWITCH

Slide the **MOBILE/LIGHT PLAY SWITCH** to select the desired setting. (🎵💡) plays lights and spins the mobile, (🎵) spins the mobile with no lights, (💡) plays lights only.



4. VOLUME CONTROL

Press the volume control buttons to choose the desired volume. Press the right button to increase the volume and press the left button to decrease the volume.



5. AUTOMATIC SHUT-OFF

To preserve battery life, the **VTech® Sing and Soothe Mobile** will automatically power-down after the selected time has ended. The unit can be turned on again by pressing the music button or when the sound sensor detects baby's crying.

ACTIVITIES

- Slide the **ON/OFF/TIME SELECTOR SWITCH** to the desired time setting. You will hear a welcoming response related to the selected mode.



2. Slide the **MODE SELECTOR SWITCH** to choose a mode of play. In the story mode, you will hear a variety of sung nursery rhymes followed by children's melodies. The soothing mode plays a variety of soft melodies and nature sounds. The melody mode plays a variety of soothing melodies.



3. Press the **MUSIC BUTTON** to change the melody, song or sound that is currently playing.



MELODY LIST

1. A-Tisket, A-Tasket
2. Humpty Dumpty
3. Jack and Jill
4. London Bridge
5. Three Little Kittens
6. Old King Cole
7. Row, Row, Row Your Boat
8. Pop! Goes the Weasel
9. Sing a Song of Sixpence
10. Old MacDonald
11. Bear Went Over the Mountain
12. Farmer in the Dell
13. Little Bo Peep

14. Did You Ever See a Lassie?
15. Oh Where Has My Little Dog Gone?
16. My Bonnie Lies Over the Ocean
17. Sur le pont d'Avignon
18. Alouette
19. Shenandoah
20. Mary, Mary Quite Contrary
21. Brahms' Lullaby
22. Greensleeves
23. Pachelbel's Canon in D
24. New World Symphony
25. Serenade
26. Ode to Joy
27. Sleeping Beauty Waltz Op. 66
28. All Through the Night
29. Au Clair de la Lune
30. Moonlight Sonata
31. Rock-a-bye Baby
32. Air
33. Fur Elise
34. Sweet and Low
35. Blue Danube Waltz
36. Lavender's Blue
37. Bicycle Built for Two
38. The Swan
39. Home Sweet Home
40. Spring Song

Sing-Along Song Lyrics**Song 1**

Go to sleep my baby.
Sleep well, safe and sound.
Sweet dreams I wish for you.
Dear friends all around.
La la la la la la.
La la la la la.
La la la la la la.
La la la la la.

Song 2

Twinkle, twinkle, little star,
How I wonder what you are.

Song 3

Beautiful dreamer, wake unto me.
Starlight and dewdrops are awaiting thee.

Song 4

Rock-a-bye baby, in the tree top.
When the wind blows the cradle will rock.

CARE & MAINTENANCE

1. Keep the unit clean by wiping with a slightly damp cloth.
2. Keep the unit out of direct sunlight and away from any direct heat source.
3. Remove the batteries when the unit is not in use for an extended period of time.
4. Do not drop the unit on hard surfaces and do not expose the unit to moisture or water.

TROUBLESHOOTING

If for some reason the program/activity stops working or malfunctions, please follow these steps:

1. Please turn the unit **OFF**.
2. Interrupt the power supply by removing the batteries.
3. Let the unit stand for a few minutes, then replace the batteries.
4. Turn the unit **ON**. The unit should now be ready to play again.
5. If the product still does not work, replace with an entire set of new batteries.

If the problem persists, please call our Consumer Services Department on 01235 546810 (from UK) or +44 1235 546810 (outside UK) and a service representative will be happy to help you.

IMPORTANT NOTE:

Creating and developing **VTech®** products is accompanied by a responsibility that we take very seriously. We make every effort to ensure the accuracy of the information which forms the value of our products. However, errors sometimes can occur. It is important for you to know that we stand behind our products and encourage you to call our Consumer Services Department on 01235 546810 (from UK) or +44 1235 546810 (outside UK) with any problems and/or suggestions that you might have. A service representative will be happy to help you.

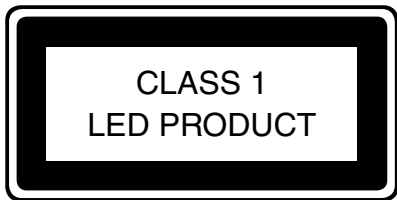

The Vtech logo consists of the word "vtech" in a lowercase, sans-serif font, with a registered trademark symbol (®) to its upper right. The text is white and is set against a dark, horizontally-oriented oval background.

PRODUCT WARRANTY



Thank you for choosing this quality product from VTech. We hope it will bring many hours of entertainment, imaginative play and learning.

1. The product detailed above is covered by a one year warranty from the date of purchase, against any defects in materials or workmanship.
2. The product may be returned to the place of purchase. Alternatively the product can be returned to VTech Electronics Europe plc (see address below), with proof of purchase, without proof of purchase no replacement will be provided.
3. VTech Electronics Europe plc will examine the product and if it is found to be defective due to faulty materials or workmanship, will replace the product at their discretion.
4. If the product covered by this warranty is damaged due to misuse, modification or unauthorised repair, or because of faulty batteries, battery discharge or incorrect electrical connections, then this warranty becomes void.
5. This warranty is personal to the original purchaser and is not transferable.
6. Breakages to the LCD screen are not covered by the warranty.
7. Returns to VTech Electronics Europe plc should include a cheque or postal order for £1.50 towards the cost of return postage and packaging.
8. Products returned to VTech Electronics Europe plc, should be addressed as follows and packed carefully to avoid damage in transit (Please do not include batteries or adaptor).
Please include details of the fault together with your name and address.

VTech Electronics Europe plc, c/o Tablogix Limited, 200 Milton Park, Abingdon, Oxon OX14 4TA

THIS WARRANTY IS OFFERED AS AN EXTRA BENEFIT AND DOES NOT AFFECT CONSUMERS' STATUTORY RIGHTS.

This warranty is valid for the UK and Eire only. For products purchased outside the UK and Eire, please contact your local distributor or place of purchase.

